

Building in rear built in  
1866: Shop in foreground  
erected 1867.

The two building on right  
erected 1867. The factory  
on the left built in 1868.  
The Cottage shown <sup>was</sup> owned by  
George Boyd and later  
removed.

EARLY PERMANENT BUILDINGS  
~~FONDAS~~ ONTARIO





1867

1866



1868

1867

ORIGINAL SHOPS OF McKECHNIE & BERTRAM  
DUNDAS, C.W.



# Canada Tool Works.

## Plan of Buildings.

Scale: 1<sup>in.</sup> = 40ft.

1886

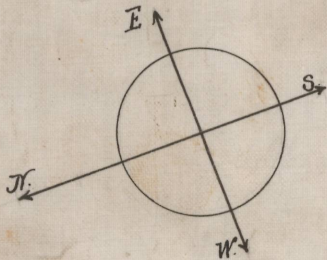

6<sup>in</sup> Cast Iron Pipe from Street.

Hall Street.

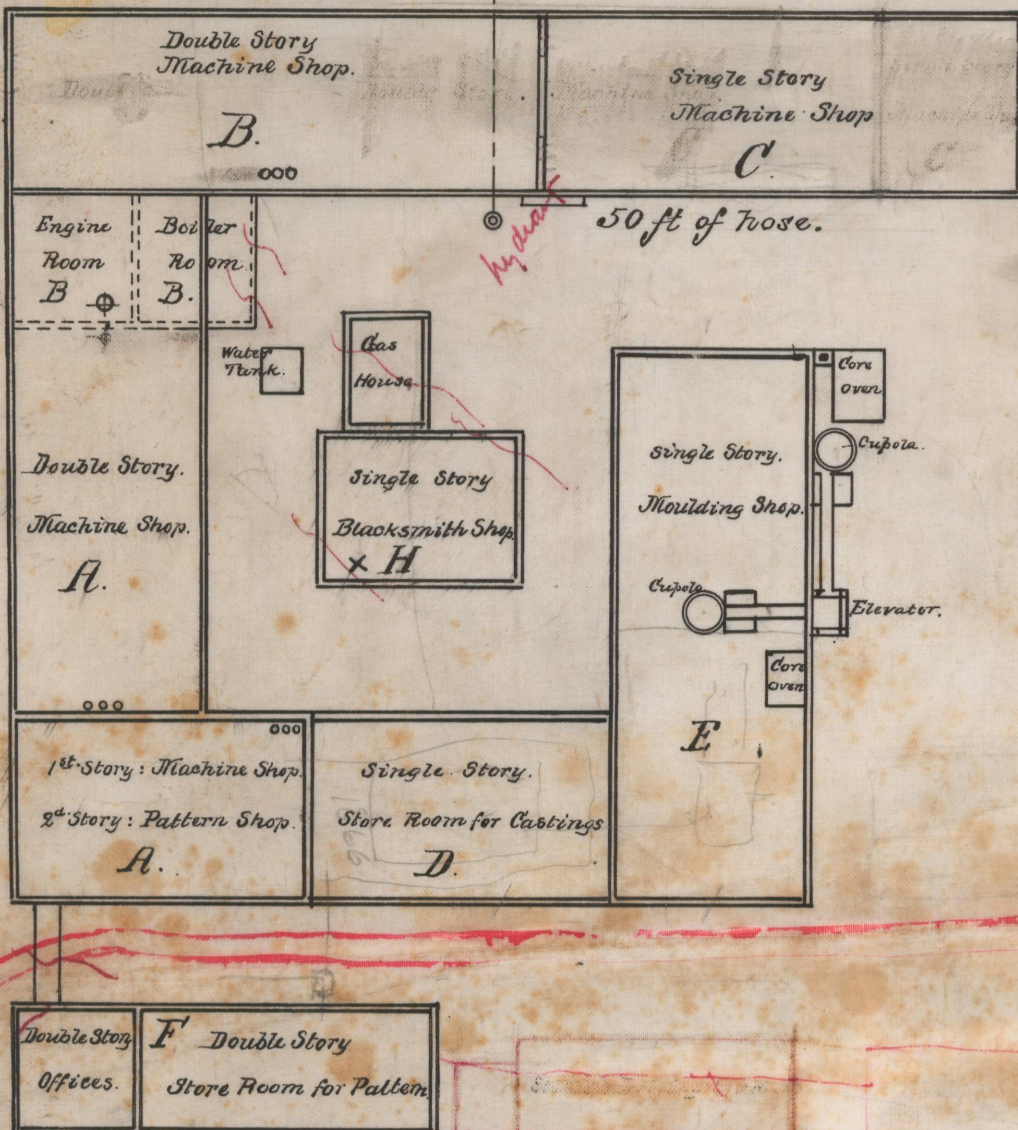

Bridge

Mill Race.

Bridge

"X" Stationary Hand Engine attached to Tank.

"⊙" Stand pipe & Hose connected with Steam Fire Pumps.

"ooo" Tanks & Pails.

"⊙" Hydrant



# CANADA TOOL WORKS

## PLAN OF BUILDINGS

SCALE 1 IN. = 40 FT.

1886

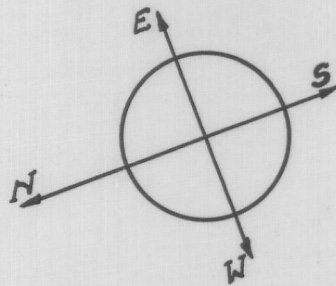

6" CAST IRON PIPE FROM STREET

HATT STREET

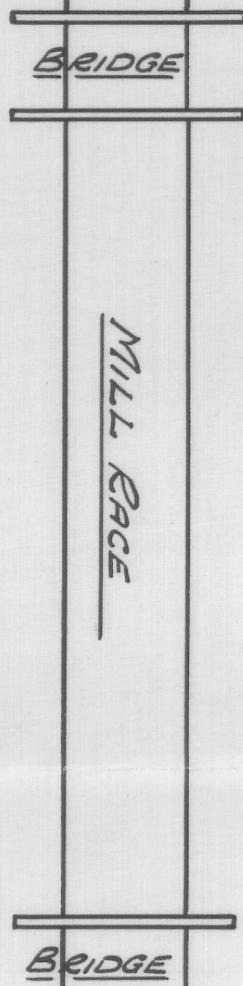
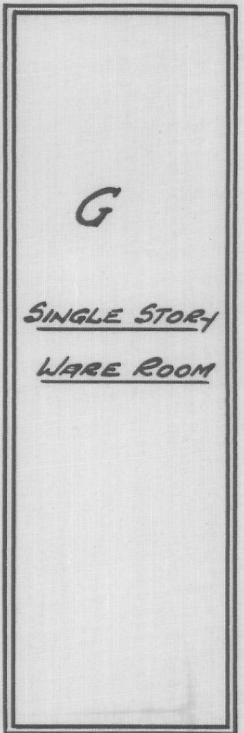
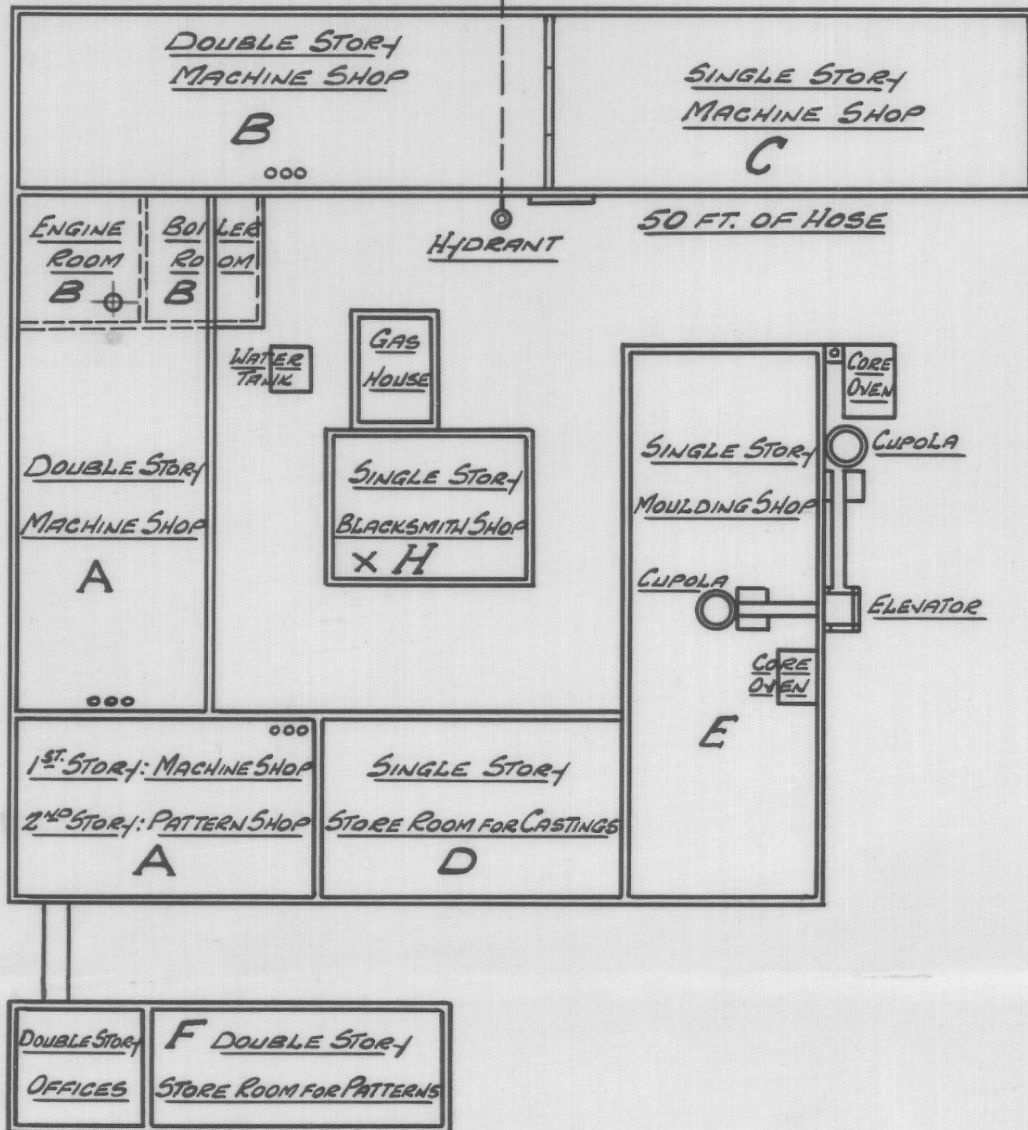

"X" STATIONARY HAND ENGINE ATTACHED TO TANK

"⊕" STAND PIPE & HOSE CONNECTED WITH STEAM FIRE PUMP

"ooo" TANK & PAIRS

"⊙" HYDRANT



63 ft. long, 41-1/2 ft. wide, 23' height of walls.  
This refers to Brick Shop North-West corner  
Building, #13 on plan. I remember the floor  
being laid at the finish.

aug 19/86

Henry Bertram

Windsor March 3 / 66

I hereby agree to put up a Brick  
Building for Messrs W. & J. Bertram  
of the following dimensions, that is in  
length 63 feet, width 41 1/2, height 23,  
Walls to be one brick and half thick to  
height of square the gables from that  
to be one brick thick for the sum of  
one thousand and five dollars

<sup>plus</sup>  
I hereby agree to build the stone foundation  
for the above to average 3 feet high  
and four cross walls for carrying joists  
to average 2 feet high for the sum of  
one hundred and eighteen dollars, and  
I agree to furnish all materials required  
in the above at the above prices

Horatio Palmer



Payments to be made as follows

300 Cash during Progress of building

150 Orders during Do Do

250 Cash 1<sup>st</sup> Sep 1866

175 Cash 1<sup>st</sup> Nov 1866

250 Cash 1<sup>st</sup> May 1867

1125

Wm. Brown  
Cochran  
in Stock



Tundas Feby 1<sup>st</sup> 1868

Messrs Mc Kechnie & Bertram

To Horatio Palmer

1866				\$	
Mar	3	To amt of building Shop per contract	-----	1123.	00
June	2	" 7 $\frac{1}{2}$ days beam filling. White Washing & plastering roof		16.	87 $\frac{1}{2}$
"	"	" 8 $\frac{1}{2}$ " " " Laborer	\$ 112 $\frac{1}{2}$	9.	56
"	"	" 15 bu lime @ $\frac{1}{15}$	-----	2.	25
"	"	" 3 loads Sand @ $\frac{1}{75}$		2.	25
"	"	" 588 brick @ $\frac{1}{6}$ pr 1000		3.	52
"	"	" extra digging	-----	3.	50
"	"	" 2 window Sills @ 1.80		3.	60
Aug	25	" $\frac{1}{2}$ day at Blacksmith chimney	\$ 2.25	1.	12 $\frac{1}{2}$
"	"	" $\frac{1}{2}$ " " " " Laborer	\$ 112 $\frac{1}{2}$	.	56
"	"	" 2 bus lime @ $\frac{1}{15}$		.	30
				1166.	54
Jan	26	To cut stone for foundation of lathe	-----	6.	00
"	"	" 2 loads stone @ 112 $\frac{1}{2}$		2.	25
"	"	" 4 bu lime @ $\frac{1}{25}$		1.	00
"	"	" $\frac{1}{2}$ day teaming @ 3.00		1.	50
"	"	" 2 days at foundation @ 2.25		4.	50
"	"	" 2 " " " Laborer @ 112 $\frac{1}{2}$		2.	25
June	29	" 3 days at Blacksmith forge @ 2.25		6.	75
"	"	" 3 " " " Laborer @ 112 $\frac{1}{2}$		3.	37 $\frac{1}{2}$
"	"	" 1 load Sand @ 12 $\frac{1}{2}$		.	12 $\frac{1}{2}$
"	"	" 4 bu lime @ $\frac{1}{25}$		1.	00
July	20	X " amt of building Moulding Shop per contract		982.	00
Aug	24	" 1 day repairing boiler furnace @ 2.25		2.	25
"	"	" 1 " " " Laborer @ 112 $\frac{1}{2}$		1.	12 $\frac{1}{2}$
"	"	" 200 brick @ 6.50		1.	30
"	"	" Mortar	-----		75
Nov	9	" 15 days at boiler house, Cupola, & Furnace @ 2.25		33.	75
"	"	" 14 " " " " Laborer @ 112 $\frac{1}{2}$		15.	75
"	"	" Mortar for Stone Work	-----	1.	00
				2233.	21 $\frac{1}{2}$



1867			\$	¢
Nov	9	To amt brought forward	2233.	21½
"	"	" Cut Stone	1.	00
"	"	" 6 loads Stone @ \$112½	6.	75
"	"	" 100 fire brick @ \$6.50 per 100	6.	50
"	"	" 1814 brick in Cupalo @ \$6.50	11.	80
"	"	" 3300 brick in boiler house & furnace @ \$6.50	21.	45
"	"	" Mortar in brickwork	10.	00
Oct 1868	5	" Rough Casting per Contract	53.	00
Feb'y	1	" Interest on payment due 1 <sup>st</sup> May 1867	11.	25
"	"	" Interest on payment due Nov 1 <sup>st</sup> 1867	3.	00
			2357.	96½

Contra Cr					\$	¢
1866						
Mar	31	By Cash on a/c			40.	00
Apl.	7	" " "			40.	00
"	14	" " "			36.	00
"	21	" " "			40.	00
"	28	" " "			40.	00
May	6	" " "			54.	00
"	16	" " "			50.	00
Sept	22	" " "			130.	00
Decr 1867	31	" " "			255.	00
Mar	9	" " "			784.	00
Aug	3	" " "			40.	00
"	31	" " "			40.	00
Sept	7	" " "			50.	00
"	14	" " "			50.	00
Oct	5	" " "			40.	00
"	19	" " "			50.	00
"	26	" " "			50.	00
Nov	2	" " "			80.	00
		" Less stone work			22.	50
		" Less Brick work			8.	45
					1299.	95



