

CANADA TOOL WORKS
 Cable Address
 "BERTRAM, DUNDAS"
 A.B.C. Code 4th Edition.
 Western Union Code,
 Universal Edition.

QUOTATIONS subject to change without notice.
 All agreements are contingent upon strikes, accidents
 and other delays beyond our control.

The John Bertram & Sons Co., *Manufacturers of* **MACHINE TOOLS.** **LIMITED.**

Dundas, Ontario,
Canada.

Aug. 21st, 1905

Mr. H. Bertram,

Dundas, Ont.,

Dear Sir:-

I hereby confirm sale of 11 acres of land, more or less, situated between the G.T.R. property and Witherspoon Street and including two lots below the hill in the Witherspoon survey, and being all of that property owned by me as per such deeds in my possession, and also such portion as fenced by George Manning, which fence they agree to remove, and give possession of. On the property is included the sand pits with McNeeley contract, he to have sand from pits as per my agreement until end of year at 20¢ per load, and I will collect all accounts from him to Aug. 21st, you to have proceeds of all sales hereafter. The purchase price for above to be One Thousand Dollars (\$1000.00).

I hereby acknowledge \$5.00 on account of bargain, the purchase price to stand until title deeds are prepared, at an annual interest of 5% until the whole is paid.

Yours very truly,

Horatio Bertram

Accepted:

Henry Bertram

Gibson, Osborne, O'Reilly & Levy.
Barristers, &c.
Hamilton, Canada.

HON. J. M. GIBSON, K.C. W. W. OSBORNE. M. J. O'REILLY. G. H. LEVY.

Hamilton. 26th April 1907.
(CANADA)

The John Bertram & Sons Company, Limited.

D U N D A S . O N T.

Dear Sirs,

Manning v Bertram

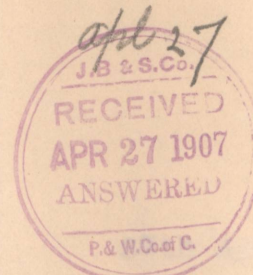

This action having been settled we are now returning to you, per express, the title deeds and other papers in this connection which you sent to us, as follows:-

- ✓ 1. ✕ Quit Claim deed dated Aug. 25th 1905 Manning to Palmer. ✓
 - ✓ 2. ✕ Deed dated 13th September 1872 Osler et al to Witherspoon ✓
 - ✓ 3. ✕ Deed dated September 8th 1880 Witherspoon to Palmer. ✓
 - ✓ 4. ✕ Deed dated 29th December 1841 Bennett et al to Leslie. ✓
 - ✓ 5. ✕ Unexecuted mortgage Witherspoon to Leslie. ✓
 - ✓ 6. ✕ Cancelled mortgage Witherspoon to Leslie. ✓
 - ✓ 7. ✕ Deed dated 28th Feby. 1891 Hickey to Palmer. ✓
 - ✓ 8. ✕ Mortgage dated 6th May 1879 Witherspoon to Wilson. ✓
 - ✓ 9. ✕ Notice of sale dated July 28th 1880 Wilson to Witherspoon. ✓
 - ✓ 10. ✕ Abstract of title in Woods v Sommerville.
 - ✓ 11. ✕ Assignment of mortgage dated 28th September 1858 Hamilton to Sommerville. ✓
 - ✓ 12. ✕ Deed dated 21st May 1872 Leslie to Witherspoon. ✓
 - ✓ 13. ✕ Horace Palmer plan Witherspoon St. signed by J. McIntosh P.L.S. ✓
 - ✓ 14. ✕ Agreement in form of letter dated 6th Sept. 1880 Wilson to Palmer.
 - ✓ 15. Description of land sold to Henry Witherspoon.
- Will you kindly acknowledge receipt of these documents?

Yours truly,

Gibson Osborne O'Reilly & Levy

27th April/07.

Messrs. Gibson, Osborne, O'Reilly & Levy,
Hamilton, Ont.

Dear Sirs:-

MANNING v BERTRAM

We have your favor of the 26th inst. enclosing the following documents in connection with the above:-

- + 1. Quit Claim Deed dated Aug. 25th, 1905, Manning to Palmer.
- + 2. Deed dated 13th September 1872 Osler et al to Witherspoon
- + 3. Deed dated September 8th 1880 Witherspoon to Palmer
- + 4. Deed dated 28th December 1841 Bennett et al to Leslie.
- + 5. Unexecuted Mortgage Witherspoon to Leslie.
- + 6. Cancelled Mortgage Witherspoon to Leslie.
- + 7. Deed dated 28th Feby. 1891 Hickey to Palmer.
- + 8. Mortgage dated 6th May 1879 Witherspoon to Wilson.
- + 9. Notice of Sale dated July 28th 1880 Wilson to Witherspoon.
- 10. Abstract of Title in Woods v Somerville
- + 11. Assignment of mortgage dated 28th September 1858 Hamilton to Somerville.
- + 12. Deed dated 21st May 1872 Leslie to Witherspoon.
- + 13. Horace Palmer plan Witherspoon St. signed by J. McIntosh P.L.S.
- + 14. Agreement in form of letter dated 6th Sept. 1880 (Wilson to Palmer).
- 15. Description of Land sold to Henry Witherspoon.

Yours truly,

NH sud

J M & S to Clerk Sini

TOWNSHIP OF WEST FLAMBORO

LOT 13

LOT 14

CONCESSION 1

LOT 15



T.H. AND B.R.Y.
PROPOSED SIDING
FOR
CANADA CRUSHED STONE CORP. LTD.
DUNDAS ONT.

Office of Asst Engineer Hamilton

Feb. 7th 1921

1" = 100'

May 25, 1921.

The Canada Crushed Stone Corpn. Limited,
Dundas, Ont.

Gentlemen;-

Replying to your favor of the 19th of April
in which you make an offer for the purchase of
certain property of our Company adjoining your
Stone Quarry, I wish to say that the writer dis-
cussed the matter with our Directors when here,
and they have decided not to dispose of the property
in question.

Yours very truly,

Treasurer.

Henry Bertram
-HEW-

Canada Crushed Stone
Corporation, Limited

CRUSHED STONE
FLUX STONE
BUILDING STONE
BLAST FURNACE SLAG

Dundas,

Ontario.

May 26/21.

The John Bertram & Sons Co. Ltd.,
Dundas, Ont.

Dear Sir:-

Attention of Mr. Henry Bertram.

Your favor of the 25th inst. received, and we note that your Directors are not disposed to sell the whole of the property. Therefore, we would like to know what you think would be a fair price for the property where we have placed the Siding and the Waste Bank immediately to the south of same, or, if you desire, I will come down and discuss this matter with you at your pleasure.

Yours very truly,

CANADA CRUSHED STONE CORPORATION, LTD.

M. Hoolitt
President.

RECEIVED

MAY 27 8 55 AM 1921

May 30, 1921

The Canada Crushed Stone Corporation Ltd.,
Dundas, Ontario.

Mr. C. M. Doolittle,
President.

Gentlemen:-

We wish to acknowledge receipt of your favor of the 26th, and to say that we are disposed to treat you fairly with regard to a small slice of the land bordering on the Grand Trunk siding for your switching purposes.

We think you should furnish a properly laid out plan which would pass as a title to the property before we discuss the matter further, and on this plan you could indicate how much of this land you are now actually using, and what further you need.

Yours very truly,

Treasurer.

Henry Bertram
-HBW-

CANADA CRUSHED STONE CORPORATION, LIMITED.

DUNDAS, ONTARIO,

February 16th. 1923.

Mr. G.H. Levy,
c/o Gibson, Levy & Gibson,
Hamilton, Ontario.

Dear Sir:- Re Bertram Property.

Your favor of the 8th received.

Enclosed you will find our file on this matter, also a blue print drawing of same from MacKay & MacKay.

We would like to arrange to purchase that property as designated by pencil marks, being about 90 feet at the westerly end by 30 feet at the easterly end, and about 386 feet long.

I know Mr. Bertram is being very fair in this matter and I know the same should have been attended to before, but this is one of the little things that sometimes are allowed to let drag.

Will you please take this matter up with Mr. Washington, and see how much they think this strip of land should be worth.

Yours very truly,

CANADA CRUSHED STONE CORPORATION, LTD.

"C. M. Doolittle".
President.

Enc.

386

30

60

386
30
$$\begin{array}{r} 11580 \\ 5790 \\ \hline \end{array}$$

17.370 sq ft.

1 acre 43.560 sq ft

*Washington, Martin & Bowlby,
Barristers, Solicitors, &c.*

S. F. WASHINGTON, K.C.

F. R. MARTIN

C. W. REID BOWLBY

F. P. L. WASHINGTON

A. J. CRERAR

HAMILTON PROVIDENT CHAMBERS

7 HUGHSON ST. SOUTH

Hamilton, Canada
Feby. 20th, 1923.

John Bertram & Sons, Limited,

Dundas, Ont.

Dear Sirs:-

Re Canada Crushed Stone Co.

Our senior member is laid up with La Grippe and has instructed us to forward you the enclosed correspondence and plan with the request that you will let him have your instructions at as early a date as possible.

**THE JOHN BERTRAM
SONS CO. LTD.**

Yours truly,
Washington, Martin & Bowlby
Per *J*

Encs.

FEB 21 9 56 AM 1923

TREASURERS OFFICE

January 30, 1924

Canada Crushed Stone Corporation, Ltd.

Dundas, Ontario,

Gentlemen,

Mr. C. M. Doolittle, President,

This will refer back to your letter of February 16th, 1923, to your Solicitors re Bertram property which you require for right of way to your siding. This matter has been carried on to the extent of now obtaining a satisfactory agreement with you regarding the use of the sidings by our Company to gain access to their property, if at any time same shall be required. We would therefore suggest a price of \$350.00 as a basis of the price of this strip of land mentioned in the MacKay survey.

Will you be good enough to reply at an early date, stating if same is satisfactory and instructing your Solicitors to prepare such an agreement as will be satisfactory to both parties. Please let us have same at your earliest convenience.

Yours very truly,

Treasurer,

Henry Bertram
-ACD-

Canada Crushed Stone Corporation, Limited

CRUSHED STONE
FLUX STONE
AGRICULTURAL
LIMESTONE

Dundas,

Ontario, Feb. 4/24.

Messrs. John Bertram & Sons Co. Ltd.,

Dundas, Ont.

Dear Sirs:-

Attention: Mr. Henry Bertram.

Answering your letter of the 30th ult., the price mentioned in your letter; namely, \$ 350. for the right of way to our Siding is perfectly satisfactory to us, and we are writing to our solicitors, Messrs. Gibson, Levy, Scott & Inch to prepare the necessary Agreement. They no doubt will act in conjunction with your solicitor, Mr. F. S. Washington.

Yours truly,

CANADA CRUSHED STONE CORPORATION, LTD.

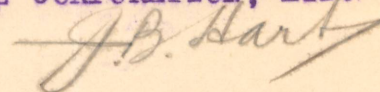

Secretary.

Canada Crushed Stone
Corporation, Limited

February 13, 1924

S. F. Washington, Esq.,
Washington, Martin & Bowlby, Barristers,
Hamilton Provincial Loan Bldg.,
Hamilton, Ontario,

Dear Sir,-

We are sending you herewith the papers in connection with the transfer of a strip from our land known as the Witherspoon Property. The strip required by the Canada Crushed Stone Corporation is 30 ft. wide at one end, 90 ft. wide at the other end and 386 ft. long, as explained in their letter of February 16th, 1923, to Mr. G. H. Levy, and the price is \$350.00 to be paid upon completion of the contract.

It is important that the agreement state clearly that we are to have free use of the Switch of the Canada Crushed Stone Corporation to secure access to our property from the C.N. Ry. tracks and that we shall be at liberty at any time to lay other tracks to cross or connect with their switch. We expect to receive the same consideration as though dealing directly with the Railway Company, subject, of course, to the rules and regulations governing the construction of Railway sidings.

In other words, we must be in a position to secure the same privileges from the Canadian National Railway as we would if this strip of land were not sold.

Please check over the agreement when drafted and advise us if all points are covered. A certified plan of the property should accompany the deed.

S. F. Washington, Esq., Hamilton, Ont.

We are sending herewith the correspondence covering this sale and the following deeds.

WITHERSPOON PROPERTY

Christina Palmer to Geo. Grighmire	1909	/
Christina Palmer to John Bertram & Sons		
Company	1909	/
Manning to Palmer	1905	/
Thos. Hickey to H. Palmer	1891	/
Eliz. Witherspoon to H. Palmer	1880	/
R.T. Wilson to Eliz. Witherspoon	1880	/
Eliz. Witherspoon to R.T. Wilson	1879	/
B.B. Osler et al to Henry Witherspoon	1872	/
John Leslie to H. Witherspoon	1872	/
H. Witherspoon to J. Leslie	1872	/
" " "	1872	/
Dr. J. Hamilton to Robt. Somerville	1859	/
Robt. Somerville to John Leslie	1841	/
Plan by Jas. Mackintosh	1873	/
Letter to R.T. Wilson from		
Plamer & Hickey	1880	/
Option H. Palmer to H. Bertram	1905	/

*checked
Nov 8-1929*

Yours very truly,

Henry Bertram
-AGD-

S. F. Washington
Washington, Martin & Bowley, Barristers,
Hans. Prov. Law & Bldg.

Canada Crushed Stone
Corporation Ltd

We are sending you herewith the papers in connection with the transfer of a strip from our land known as the Witherspoon Property. The strip required by the Canada Crushed Stone Corp is 30 ft wide at one end, 90 ft wide at the other end and 386 ft long as explained in their letter of Feb 16-1923 to Mr. S. H. Levy, and the price is 350⁰⁰ to be paid upon completion of the contract.

It is important that the agreement state clearly that we are to have free use of the Switch of the Can Crush Stone Corp. to secure access to our property ^{from the C. N. Ry tracks} and that we shall be at liberty any time to lay other tracks to cross or connect with their switch. ~~In other words~~ we expect to receive the same consideration as though dealing directly with the Railway Company subject of course to the rules and regulations governing the construction of Railway Sidings.

In other words we must be in a position to secure the same privileges from the Can Nat Ry as we would if this strip of land were not sold.

Please check over the agreement when drafted and advise us if all points are covered. A certified plan of the property should accompany the deed.

We are sending herewith the correspondence covering this sale and the following bids:-
Witherspoon Property

D. T. T. I

Canada Crushed Stone Corporation, Limited

CRUSHED STONE
FLUX STONE
BUILDING STONE
BLAST FURNACE SLAG

Dundas,

Ontario, April 19/21.

Mr. Henry Bertram,
Secretary Treasurer,
John Bertram & Sons Ltd.
Dundas, Ont.

Dear Sir;-

Confirming your conversation this morning re property just south of the Grand Trunk Railway, through the northerly portion of this property we have constructed our new siding.

We beg to offer you \$500.00 per acre for this property, \$100.00 per acre being payable as soon as the property is surveyed and the balance, \$400.00 per acre, being payable a year from date of first payment.

Hope you will accept this very little offer we are making,

Yours very truly,

CANADA CRUSHED STONE CORPORATION Ltd.

C. M. Doolittle

President.

Will not sell

Gibson, Levy, Scott & Inch
Barristers &c.

SIR JOHN M. GIBSON, K.C.

G. H. LEVY, K.C.

C. W. G. GIBSON

S. W. C. SCOTT

R. F. INCH

Hamilton, 15th May, 1924.
CANADA.

Messrs Washington Martin & Bowlby,
Barristers &c.,
Hamilton, Ont.

MAY 15 1924

Dear Sirs,

Re Canada Crushed Stone & Bertram.

We are returning the two Deeds contained in your letter of the 18th of February, namely No. 1069 Dundas and No. 8984 West Flamboro. We also enclose copy of Surveyor's description and two Blue Prints.

Will you please submit draft Deed to us.

Yours truly,

Gibson Levy Scott & Inch

E/L.M.
Encls.

*Washington, Martin & Bowlby,
Barristers, Solicitors, &c.*

S. F. WASHINGTON, K.C.
F. R. MARTIN
E. P. L. WASHINGTON
C. W. REID BOWLBY
A. J. CRERAR

FRM/K

HAMILTON PROVIDENT CHAMBERS
7 HUGHSON ST. SOUTH

Hamilton, Canada

May 20th, 1924.

The John Bertram & Sons Company Ltd.,
DUNDAS, Ontario.

Dear Sirs:- RE: You and Canada Crushed Stone

They we have at last completed the survey herein
and ^{we} enclose draft of the Deed with blue print attached which
we would be much obliged if you would go carefully over
taking particular notice of the reservation clause at the
end of the description and let us know if it covers all
the points that you wish to be protected against. If so,
please return it and we will submit it for approval to
the Solicitors for the Canada Crushed Stone Company.

Yours truly,

Washington, Martin & Bowlby

Per: *R. Bowlby*

Enc-

RECEIVED

MAY 21 9 37 AM 1924

REFER

May 23 -
L E D says nothing was
paid and no action was
taken to make out a new deed

Wash. promised to read
the letters over again as he
had forgotten about the price

880⁰⁰ -

Railroad

all month
1975
May

car shed
for four
land rented

black c
huts 9x10

east 17' of lot 10
was used to
grow grapes

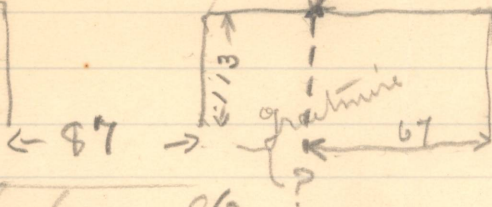

weatherproof st.

main

Nov 1929

Had Mr Latham & Malcolmson met
about first of nov re purchase of sand
pit.

Mr Latham advises frontage is about 810
feet long and at rear 742 (this is an error)
They want a strip 200 ft wide along
the front or perhaps the entire lot.

$$\begin{array}{r} 810 \\ 200 \\ \hline 162000 \end{array}$$

Canada Crushed Stone Co.

May 21, 1924

Washington, Martin & Bowlby,
Hamilton Provident Chambers,
HAMILTON, Ont.

Gentlemen;

Attention Mr. Washington

We acknowledge your letter of May 20th enclosing draft of deed covering the portion of our land adjoining the Canadian National Railway track which the Canada Crushed Stone Company wish to purchase.

Referring to our previous letter to you, we find that the area to be taken over was to be 30' ^{2nd 13} long at one end, 90' at the other, and approximately 386' long. The section marked on the Blue Print is considerably larger than what we had under consideration. Please check up and advise us the reason for this change.

Yours very truly,

The John Bertram & Sons Co. Ltd.

Area = 43,560 sq ft.

Peri 60 - 30 - x 386 = 23160 sq ft.

Cashier

H.G. Bertram
-GT-

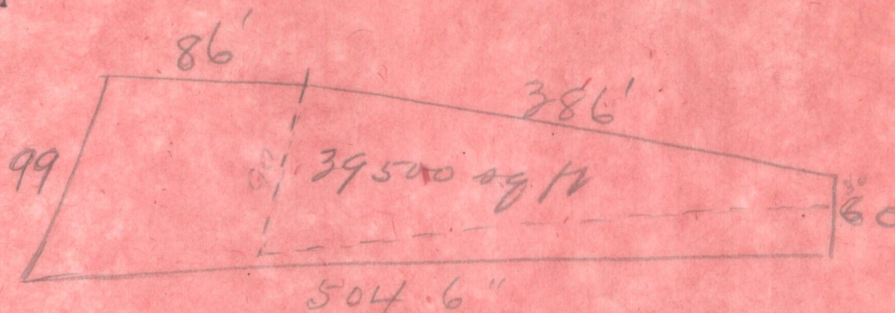

The draft of deed is enclosed

*Washington, Martin & Bowlby,
Barristers, Solicitors, &c.*

HAMILTON PROVIDENT CHAMBERS
7 HUGHSON ST. SOUTH

Hamilton, Canada

S. F. WASHINGTON, K.C.
F. R. MARTIN C. W. REID BOWLBY
F. P. L. WASHINGTON A. J. CRERAR

May 23rd, 1924.

John Bertram & Son Co., Ltd.,

Dundas,

Ont.

Dear Sirs:--

Re Canada Crushed Stone Co.

We return herewith the draft Deed with the blue print attached. If you will look at the description of the property you will find that what the Stone Co. want is the parcel within the yellow line, measuring 39,500 square feet. You will have to negotiate further with the Stone Co. as to the price if you are willing to give them this amount of land. This comprises, as we understand it, far more than you agreed to sell them. When you have fixed the price to be paid will you have Mr. Henry Bertram go carefully over the reservations in the deed as to the switches &c. so as to be sure that you are getting all that he wants.

Yours truly,

Washington, Martin & Bowlby

per

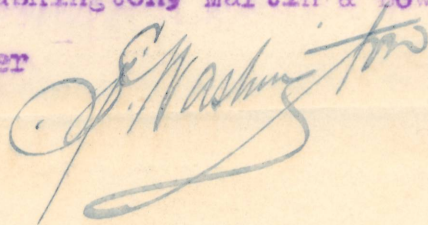

Enc.

RECEIVED

THE JOHN B. BERTRAM

MAY 26 9 05 AM 1924

REFER

CANADA CRUSHED STONE COMPANY

June 9, 1924

Washington, Martin & Bowlby,
Hamilton Provident Chambers,
Hamilton, Ont.

Gentlemen,

This will acknowledge the papers which you have sent us with the draft Deed and the survey by MacKay, MacKay & Perrie. We find that this survey, as stated in ours of May 21st, covers a much larger amount of land than that incorporated in our proposal and we are therefore returning the Deed and the survey with instructions to change this to read \$850.00 for the parcel of land set forth in their survey.

Will you kindly have this matter closed up at the earliest possible moment as it has now been unduly held up.

Yours very truly,

Treasurer,

Henry Bertram
-AGD-

*Washington, Martin & Bowlby,
Barristers, Solicitors, &c.*

S. F. WASHINGTON, K.C.
F. R. MARTIN C. W. REID BOWLBY
F. P. L. WASHINGTON A. J. CRERAR

FRM/K

HAMILTON PROVIDENT CHAMBERS
7 HUGHSON ST. SOUTH

Hamilton, Canada

September 24th, 1924

The John Bertram & Sons Company Limited,
Dundas,

O n t a r i o.

Dear Sirs:-

RE: You and Canada Crushed Stone Corp.

We have succeeded at last in getting the Deed executed by the Canada Crushed Stone Corporation and we now enclose it for execution by you. We think it has been approved of by you but in any event you had better go carefully over the description in order to see that your rights are properly reserved. If you will do this and return it to us duly executed we will send a cheque for \$850.. the amount subsequently agreed on.

Yours truly,

Washington, Martin & Bowlby

Per: *[Signature]*

Encs-

RECEIVED
THE JOHN BERTRAM
& SONS CO. LTD.
SEP 25 8 52 AM 1924
TREASURY OFFICE
REFER

CANADA CRUSHED STONE CORPORATION.

September 29, 1924

TREASURER / NEW YORK,

Mr. J. B. Cornell,

Dear Sir,-

Two or three years ago, by resolution of the Board, the writer was permitted to transfer a strip of land on our property known as the sand pit adjoining the Canadian National Railways on the north side of the Town to the Canada Crushed Stone Corporation and the strip of land estimated on at that time was a very small one and we based the price of same at \$350.00, with the request that a surveyor should make measurements of the amount of land and on receipt of the surveyor's report we would sell them the land in question. On receipt of this, it was discovered that the amount of land taken by them was about double that we had agreed to give them so we made the price \$850.00, which they agreed to. We are enclosing herewith original letter from Messrs. Washington, Martin & Bowlby, together with the two deeds in question, and if you will kindly have the deeds in question signed at the point marked with an "X", and also have the affidavit on the back, marked "X", completed by an authorized Notary Public, and return same to us we will complete and collect the money in question.

You will note that we have safeguarded the balance of our property and that the rights we might in the future require for handling material over the switch are taken care of, which are all we need. The property is one,

Treasurer, New York Office,

of course, that we have no idea of ever being of value to the Company as the sand pit is situated on the south side of the property and a considerable distance from the point mentioned in these deeds.

Yours very truly,

Henry Bertram
-AGD-

Treasurer,

NILES-BEMENT-POND COMPANY

NEW YORK

PLEASE CONFINE YOUR LETTER TO ONE SUBJECT

Subject,

CANADA CRUSHED STONE CORP.

October 8th, 1924.

Mr. Henry Bertram, Treasurer,

DUNDAS :

In accordance with yours September 29th which was held up owing to my absence, we are enclosing deed in duplicate to the Canada Crushed Stone Corporation, signed by Mr. Cullen with subscribing witness' certificate, Notary Public certificate, and County Clerk's certificate.

We assume you have had the benefit of legal advice in connection with this transaction and it is satisfactory. It looks to us peculiar in some respects. As an instance, on the first page it refers "to the lands now owned by one Bertram". This strikes us as a very peculiar expression for it would indicate that an individual owned the property.

We do not like the idea of giving a warranty deed for so small and unimportant a tract as this seems to be for it might result in some sort of unpleasant consequences in later years.

We have filled out the forms on the last page as seems to apply although they are entirely strange to us and not used on this side so far as we know.

Letter of Washington, Martin & Bowlby is also enclosed.

Yours very truly,

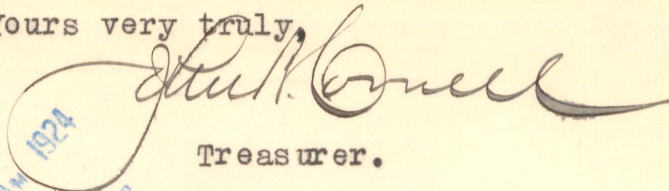

Treasurer.

JBC/HT
(Enclosure.)

RECEIVED
THE NILES-BEMENT-POND COMPANY
OCT 10 8 32 AM 1924
RECEIVED
RECEIVED

Washington, Martin & Bowlby
Barristers, Solicitors, &c.

S. F. WASHINGTON, K.C.
 F. R. MARTIN
 F. P. L. WASHINGTON
 C. W. REID BOWLBY
 A. J. CRERAR

FRM/X

HAMILTON PROVIDENT CHAMBERS
 7 HUGHSON ST. SOUTH

Hamilton, Canada

October 10th, 1924

The John Bertram & Sons Co. Limited,
 Dundas, Ontario.

Dear Sirs:- RE: You and Canada Crushed Stone Corp.

Referring to the writer's conversation with your Mr. Henry Bertram in regard to the points raised by your President in New York in connection with the Deed of the small piece of land to the Canada Crushed Stone Corporation.

We beg to say that the lands being described as part of the lands owned by one Bertram undoubtedly means the lands owned by your Company, it is simply the surveyor's way of writing out the description.

There is in the description a distinct reservation to you of the rights to operate and run cars over a spur line, to load and unload cars, to construct and maintain a spur line, switch or siding connecting with the spur line, and if the Grantee fails to construct said spur line, or if it removes the same or allows it to become unfit for traffic you have the right to construct and maintain a spur line. So, you are perfectly protected and adding anything further after the covenants would be superfluous. This is the usual form of Deed used in our Province and the covenant that the

The John Bertram & Sons Co. Limited

-2-

Grantee shall have quiet possession free from encumbrance simply means that the property shall be free of any mortgage, charge or arrears of Taxes, and the release of all claims upon the lands does not in any way affect the reservation to you in the description.

We have handed you your file and the cheque for \$850.00 so we are handing over the Deed to the Solicitors for the Canada Crushed Stone Corporation. We return the letters sent with the Deed.

Our account against you in the matter is as below.

Yours truly,

Washington, Martin & Bowlby

Per:

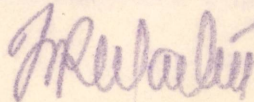

To fees drawing Deed, answering requisitions on title, interviews, correspondence, settling and closing matter.

\$25.00

Vouchered Oct 24th. 1924.

RECEIVED
JOHN BERTRAM & SONS CO. LTD.

OCT 13 11 42 AM 1924

RECEIVED OFFICE
REFER

CANADA CRUSHED STONE CORPORATION

October 14, 1924

TREASURER / NEW YORK,

Mr. J. B. Cornell,

Dear Sir,-

In reply to your favor of the 8th, we have discussed the points mentioned in your letter with our solicitors and we are enclosing herewith their original letter, in which you will note they have gone into the points mentioned and we believe the method of handling the deeds is in accordance with the practice in this country. We might say for your information that the deeds originally were between the old Bertram Company and the person from whom we purchased the land, but, in any event, the maps and descriptions are in accordance with the old deeds, which we have in our possession, and believe that will answer the purpose.

Please return the papers in question.

Yours very truly,

Henry Bertram
-AGD-

Treasurer,

NILES-BEMENT-POND COMPANY

NEW YORK

PLEASE CONFINE YOUR LETTER TO ONE SUBJECT

Subject,

Canada Crushed Stone Corp.

October 16th, 1924.

Mr. Henry Bertram, Treasurer,

D U N D A S :

We have yours 14th advising further relative to the deeding of property to the Canada Crushed Stone Corporation.

Everything seems to be in order in light of the explanation given, and we are returning the enclosures sent with your letter.

Yours very truly,

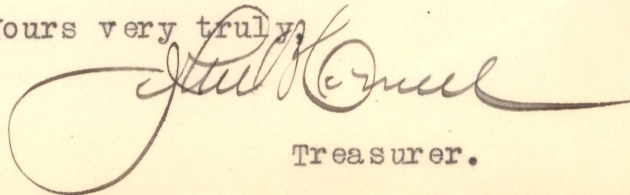

Treasurer.

JBC/HT

(Enclosure.)

RECEIVED
HENRY BERTRAM
OCT 18 9 32 AM 1924
TREASURER
REFER

Canada Crushed Stone Corporation,

November 12th, 1929.

Washington, Martin & Bowlby,
7 Hughson St. South,
Hamilton, Ont.

Gentlemen,-

From 1921 to 1924 we carried on correspondence in connection with a strip of land which the Canada Crushed Stone Corporation wished to purchase from our Company. On October 10th, 1924, Mr. Martin wrote us concluding the business and enclosing a cheque for the land under consideration. We find now that we have never received a copy of the deed for our files and we would appreciate if you will look into the matter and find out if you have the duplicate on file.

Yours very truly,

H.G. Bertram,

-AGD-

November 15th, 1929.

Toronto, Hamilton & Buffalo Railway Co.,

Hamilton, Ontario,

Gentlemen,-

Attention - Mr. Latham,

This letter will confirm our 'phone conversation in which we offered to sell to you our sand pit, north west of the Town of Dundas. This land is known as Lot 14, Concession 1, Township of West Flamboro, and consists of approximately 10 acres.

If you wish to purchase the entire block of land, the price will be \$250.00 an acre.

If you wish to purchase only a strip, 200 ft. wide, across the south of this block of land, the price per acre will be \$325.00, and in making this purchase you must agree to provide an entrance to the top of the elevation from the town side of the property.

This offer to sell at the above prices will hold good for sixty days from the date of this letter.

Yours very truly,

H.G. Bertram,
-AGD-

Secretary-Treasurer.

Washington, Martin & Bowlby Griffin
Barristers, Solicitors, &c. FRM/K

S. F. WASHINGTON, K.C.
F. R. MARTIN C. W. REID BOWLBY W. E. GRIFFIN
F. P. L. WASHINGTON

HURON & ERIE BUILDING
7 HUGHSON ST. SOUTH

Hamilton, Canada

November 20th, 1929

John Bertram & Sons Company Limited,
Dundas,
Ontario

Dear Sirs:-

RE: You and Canada Crushed Stone Co.,

Referring to your letter herein we herewith enclose a copy of the Deed to the ~~Canada~~ Crushed Stoney Company as requested which we have obtained through the kindness of their solicitors.

Yours truly,

Washington, Martin & Bowlby

Per: *H.*

Enc

THE JOHN BERTRAM
& SONS CO. LTD.
NOV 21 10 32 AM 1929
TREASURERS OFFICE
BY

November 23rd, 1929.

Washington, Martin & Bowlby,
7 Hughson St. South,
Hamilton, Ont.

Gentlemen,-

Thank you for your letter of November 20th,
and the copy of the deed to the Canada Crushed Stone
Company, Limited. I cannot understand why we did not
have a copy of this deed when the sale was made.

Yours very truly,

H.G. Bertram,
-AGD-

Washington, Martin & Bowlby & Griffin
Barristers, Solicitors, &c. FRM/K

S. F. WASHINGTON, K.C.
F. R. MARTIN C. W. REID BOWLBY W. E. GRIFFIN
F. P. L. WASHINGTON

HURON & ERIE BUILDING
7 HUGHSON ST. SOUTH

Hamilton, Canada

November 25th, 1929

The John Bertram & Sons Co. Limited,
Dundas,
O n t a r i o.

Dear Sirs:-

RE: You and Canada Crushed Stone

We beg to acknowledge receipt of yours of
23rd instant. The reason you did not have a copy of
this Deed in your files is that it was only drawn in duplicate
by the Canada Crushed Stone Company and one of the copies
of course is deposited in the Registry Office and they got
the other. If you had requested a copy of it at the time
we would certainly have got it for you.

Yours truly,

Washington, Martin & Bowlby

Per:

J. Reel

THE JOHN BERTRAM
& SONS CO. LTD.

NOV 26 9 55
A.M. 1929

TREASURERS OFFICE
BY

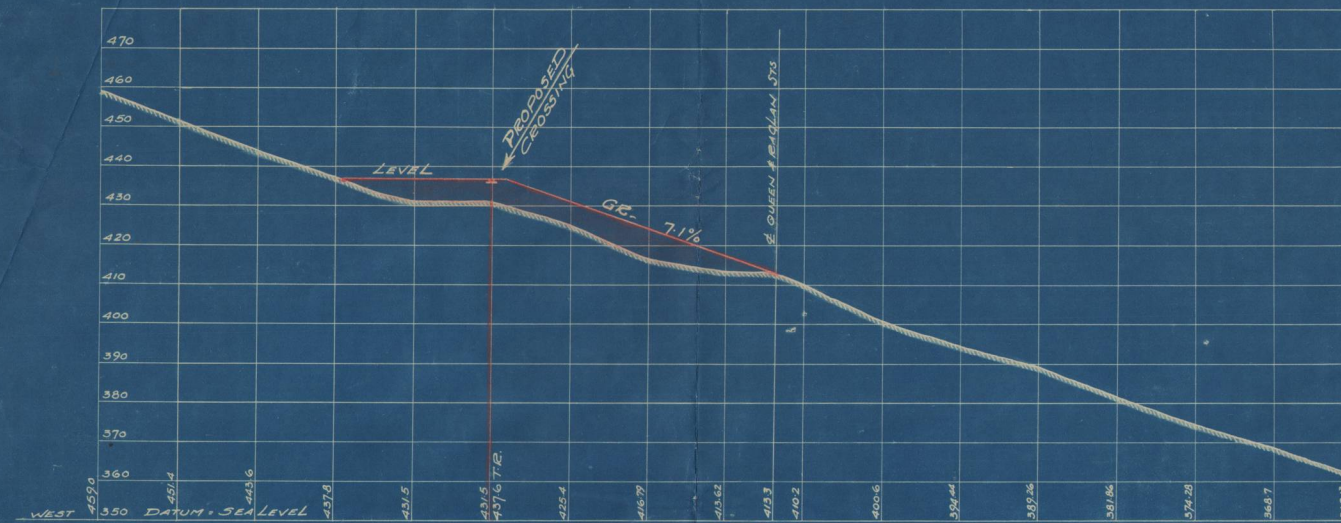

PROFILE OF RAGLAN ST

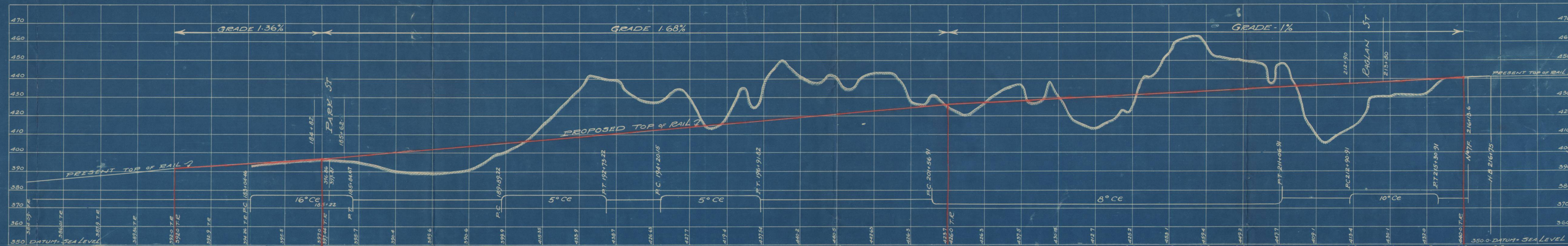

PROFILE OF PROPOSED BRANCH LINE

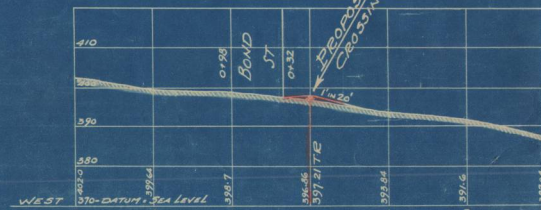

PROFILE OF PARK ST

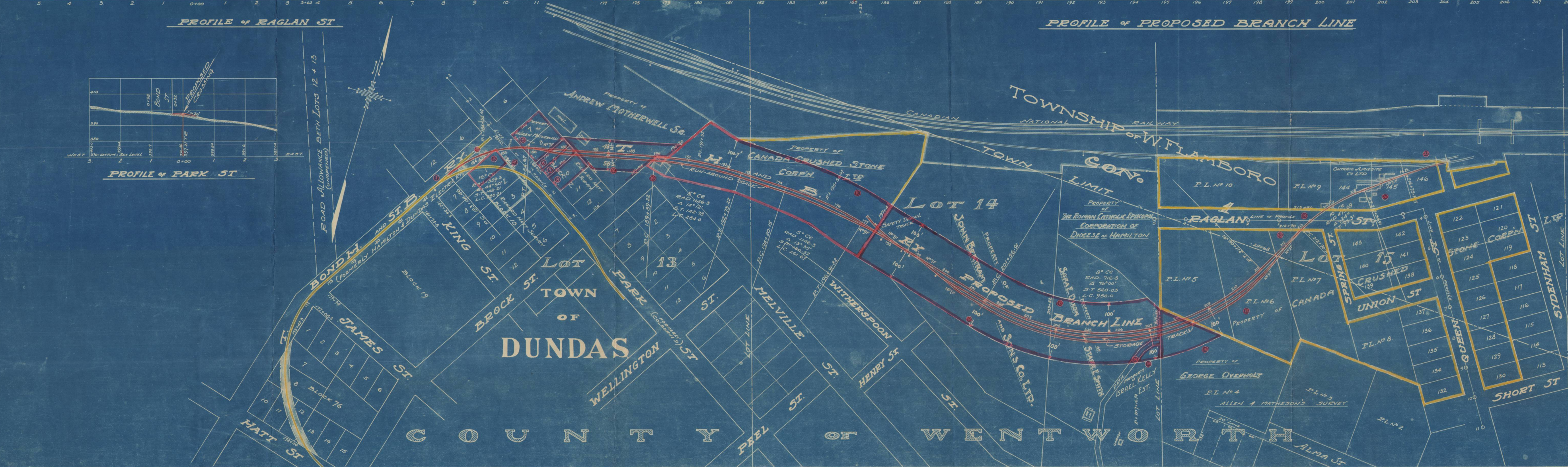

BOOK OF REFERENCE										
ITEM	OWNER	INCUMBRANCE	LOT	CON	LENGTH	WIDTH	AREA	REMARKS		
1	CORP of the TOWNSHIP OF DUNDAS	—	13	1	159'	—	—	EASEMENT ACROSS BOND ST		
2	HAMILTON & DUNDAS STREET RY CO	T & H D RY CO	13	1	—	—	—	PRESENT TRACK "B" BOND ST		
3	CORP of the TOWNSHIP OF DUNDAS	EQUITABLE CHURCH UNION (LOCAL OWNERS)	13	1	159'	—	—	EASEMENT ACROSS BOND ST		
4	HAMILTON & DUNDAS STREET RY CO	DO	13	1	185'	—	—	EASEMENT LOT 1 BLOCK 10		
5	CORP of the TOWNSHIP OF DUNDAS	—	13	1	80'	—	—	" " " " ACROSS FINE ST		
6	ANDREW MOTHERWELL JR	—	13	1	120'	120'	14400	0.35	ALL LOTS 718 & 719 FINE ST	
7	GEORGE SPENCE (DECEASED)	—	13	1	120'	30'	3600	0.08	WATER LOT 5 FUDGE FARM	
8	GEORGE SPENCE	—	13	1	120'	30'	3600	0.08	E HALF LOT 5 BLOCK 2 VACANT	
9	DESSIE & FLAMBO	—	13	1	120'	60'	7200	0.16	ALL LOT 10 BLOCK 2 VACANT	
10	ANDREW MOTHERWELL JR	—	13	1	275.5	100'	27550	0.64	VACANT LAND & FINE ST LOT 1	
11	CORP of the TOWNSHIP OF DUNDAS	—	13	1	—	—	—	EASEMENT ACROSS FUDGE FARM		
12	CAMDEN GRUNDED STONE CO	NATIONAL TRUST OF LTD (LOCAL OWNERS)	13/14	1	715'	100'	71500	2.97	EIGHT & 1/2 VACANT LAND	
13	CAMDEN GRUNDED STONE CO	—	14	1	635'	220'	127800	5.24	VACANT LAND & FINE ST	
14	BRUCE & DUNDAS	—	14	1	335'	200'	67000	1.54	DECEASED AND FINE ST	
15	SCOTT & DUNDAS STREET RY CO	—	14	1	—	—	—	EASEMENT ACROSS PATH		
16	ISRAEL KELLY ESTATE	—	14	1	186	100	18600	0.06	VACANT LAND & FINE ST	
17	GEORGE OVERHOLT	—	15	1	186	100	18600	0.07	VACANT LAND & FINE ST	
18	CAMDEN GRUNDED STONE CO	NATIONAL TRUST OF LTD (LOCAL OWNERS)	15	1	435'	—	—	VACANT LAND & FINE ST		
Twp of W FLAMBO										
19	CAMDEN GRUNDED STONE CO	NATIONAL TRUST OF LTD (LOCAL OWNERS)	15	1	132'	—	—	VACANT LAND & FINE ST		
20	CORP of the TOWNSHIP OF DUNDAS	—	15	1	90'	—	—	EASEMENT ACROSS ENGLAND ST		
21	CAMDEN GRUNDED STONE CO	NATIONAL TRUST OF LTD (LOCAL OWNERS)	15	1	295'	—	—	EASEMENT, PART OF ENGLAND ST		
22	CAMDEN NATIONAL RY CO	—	15	1	—	—	—	PROPOSED CONNECTION WITH		

DUNDAS 2 BRANCH
THE TORONTO-HAMILTON AND BUFFALO RAILWAY CO.
 PLAN-PROFILE AND BOOK-REFERENCE
PROPOSED BRANCH LINE
 UNDER SECTIONS 180 TO 184 OF THE RY. ACT OF 1919
 THROUGH THE
 TOWN OF DUNDAS AND TWP. OF W. FLAMBORO
 TO SERVE
CANADA CRUSHED STONE CORPORATION LTD
 WENTWORTH CO. - PROVINCE OF ONTARIO
 SCALES
 PLAN 1 in. = 100 FT. - PROFILE 1 in. = 100 FT. HOR. 20 FT. VERT.
 OFFICE OF CHIEF ENGINEER - HAMILTON - NOV. 25th 1929.
 CERTIFIED APPROVED
 W. M. McPherson
 VICE-PRESIDENT & GEN. MANAGER.
 R. B. Hamilton
 CHIEF ENGINEER.

THE BOARD OF RAILWAY COMMISSIONERS FOR CANADA

APPLICATION NO.

THE TORONTO HAMILTON AND BUFFALO RAILWAY COMPANY (herein called the Applicant Company) HEREBY APPLIES to the Board

1- For an Order under Sections 180 to 184 inclusive of The Railway Act authorizing the Applicant Company to construct maintain and operate a branch line of railway with three spurs or offsets therefrom in the Town of Dundas and Township of West Flamboro, Province of Ontario and to take the necessary lands therefor extending from a point on Bond Street in the Town of Dundas on the Applicant Company's Dundas branch line of railway and running thence north easterly along Bond Street and across Lot 1, Block 10 Richard Hatt's Survey (formerly belonging to the Hamilton and Dundas Street Railway Company but of which the Applicant Company and Bessie A. Fisher is the beneficial owner and in possession) to and across Park Street and thence through the lands of Andrew Motherwell, Senior, Fannie Niblock, George James, Bessie A. Fisher, and Andrew Motherwell senior to and across Brock Street and Melville Street thence through the lands of Canada Crushed Stone Corporation Limited, John Bortram and Sons Company Limited, Sarah E. Dixon, Starr E. Smith, Estate of Israel Kelly deceased, The Roman Catholic Episcopal Corporation of the Diocese of Hamilton, Estate of Israel Kelly deceased, George Overholt and Canada Crushed Stone Corporation Limited to and across Reglan Street in the Township of West Flamboro and continuing thence north easterly into and through the lands of Canada Crushed Stone Corporation Limited to a Junction with the branch line of railway of the Canadian National Railway Company situate upon the lands of Canada Crushed Stone Corporation Limited at or near a point marked HB 216+75-^{PS}₁ on plan a total distance of 3370 feet all as shown colored red upon and according to the Plan Profile and Book of Reference of the Applicant Company deposited in the Registry Office for the said County of Wentworth on the 29th day of November 1929 as Railway Plan No. 294 a duplicate of which is submitted herewith in triplicate

2- AND also for an Order under Sections 255 and 256 of The Railway Act authorizing the Applicant Company to carry said branch

line at grade level along Bond Street and across Park Street, Brock Street and Melville Street in the Town of Dundas and Raglan Street in the Township of West Flamboro in accordance with the said Plan and Profile

3- AND also for an Order under Section 252 of The Railway Act permitting the Applicant Company to join its said present and proposed branch line with the tracks of the said branch line of railway of the Canadian National Railway Company at or near the point marked on plan "H.B.216 + 75-P.S." AND STATES:

Canada Crushed Stone Corporation Limited carries on the business of manufacturing and dealing in crushed stone in the Town of Dundas and the Township of West Flamboro and desires to obtain additional railway facilities in connection with its business and it is the desire and intention of the Railway Company to create railway facilities for said business and to construct said branch line as soon as the necessary order or authority shall have been granted

AND the Applicant Company asks that the Board may dispense with notice by publication in newspapers of the Applicant Company's intention to apply to the Board under Section 181 of The Railway Act and that in lieu of such public notice the Applicant Company may serve the persons and corporations interested as shown by said Plan and Book of Reference with a copy of this Application.

DATED at Hamilton this 29th day of November 1929.

THE TORONTO HAMILTON AND BUFFALO RAILWAY COMPANY

By

P. D. Cahill
General Solicitor.

DATED NOVEMBER 29, 1929

THE TORONTO HAMILTON AND
BUFFALO RAILWAY COMPANY

-and-

THE CANADA CRUSHED STONE CORPORATION
LIMITED

et al

John Bertram Bone

APPLICATION under Sections 180 to 184 inclusive and 252 and 255 and 256 of The Railway Act to construct a branch line ~~along and across highways~~ and the Town of Dundas in the Township of West Flamboro

TAKE NOTICE that the Corporation of the Town of Dundas, the Hamilton and Dundas Street Railway Company, Bessie A. Fisher, Andrew Motherwell senior, Fannie Niblock, George James, Canada Crushed Stone Corporation Limited, John Bertram and Sons Co. Limited, Sarah E. Dixon, Starr E. Smith, Estate Israel Kelly, The Roman Catholic Episcopal Corporation of the Diocese of Hamilton, George Overholt, the Corporation of the Township of West Flamboro and Canadian National Railway Company are required to file with the Board of Railway Commissioners for Canada within 15 days from the service hereof their Answers to the within Application

The within Application is made by Edwin D. Cahill of the City of Hamilton in the Province of Ontario General Solicitor for the Applicant Company.

E.D. CAHILL
HAMILTON ONTARIO